

C.W.L (Continuous operation water level)  
L.W.L (Lowest operation water level)  
The dimension of the hose : Inner bore 25mm(1in) X Outer bore 33mm(1.3in)  
UNIT IN inch(mm)

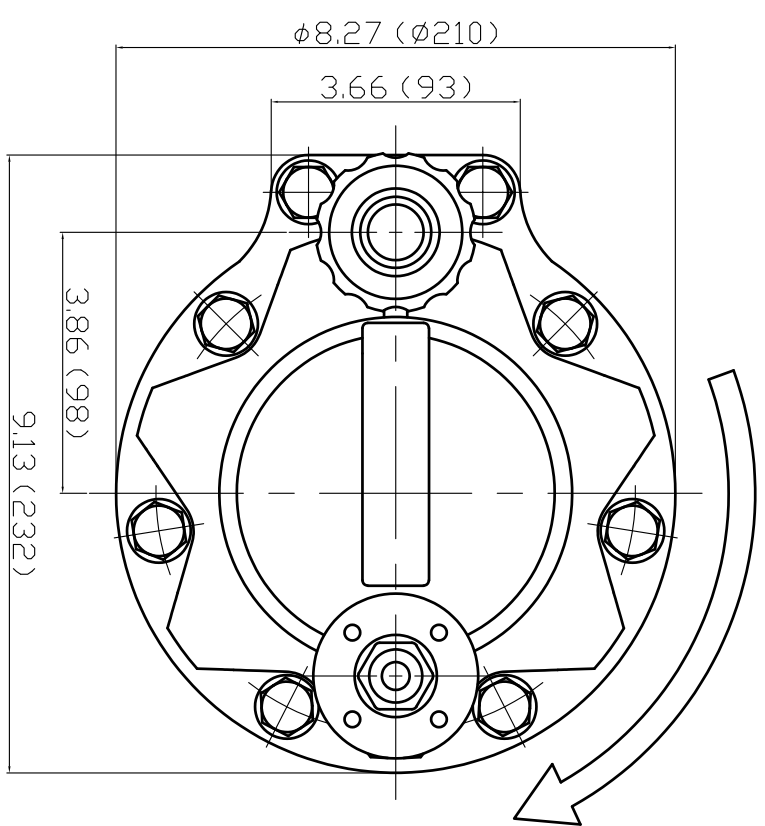
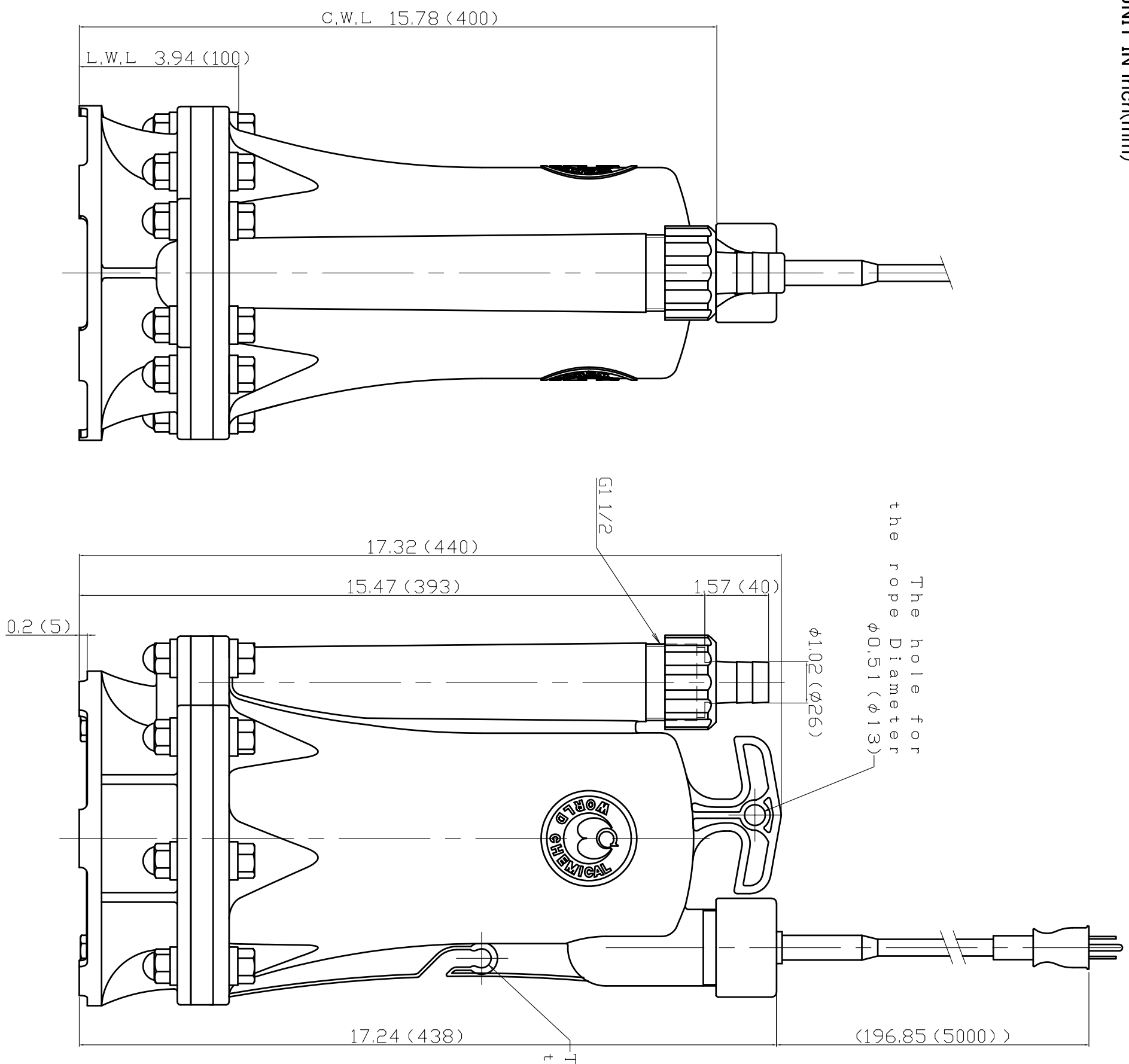

Rotational direction of the motor

The hole for the power cord

The hole for the rope Diameter  $\phi 0.51 (\phi 1.3)$

MODEL	YD-25A6GWN1-	
BORE		
TOTAL HEAD	m	
CAPACITY	L/min	
MOTOR	0.26kW(1/3HP) 2P 1 $\phi$ V 50•60Hz	
LIQUID	NAME	
	CONC.	%
	TEMP.	°C
	S.G.	

名称	SUBMERSIBLE CHEMICAL PUMP		適応機種	WCA
型式	YD-25A6GWN1-CP		ADAPTATION MODEL	
MODEL				
承認	検図	設計・製図	日付	
APPROVED BY	CHECKED BY	DRAWN BY	DATE	
MORI	UEHARA	YOSHIDA	2020/11/04	
図面番号	GM-3172-0		尺	1:3
Dwg. No.			SCALE	
株式会社 ワールドケミカル			World Chemical Co.,Ltd.	

